

Technical specification

Battery: 3V DC (CR2430)	Battery life: >2 years
Radio frequency: 433.05-434.79MHz	Working temperature: -10°C~50°C
Transmitting power: 10 mW	Radio range: 150 meters outdoor, 35 meters indoor

INGESTION HAZARD: This product contains a button cell or coin battery.

1. Remove and immediately recycle or dispose of used batteries according to local regulations and keep away from children. Do NOT dispose of batteries in household trash or incinerate.
2. Even used batteries may cause severe injury or death.
3. Call a local poison control center for treatment information.
4. Non-rechargeable batteries are not to be recharged.
5. Do not force discharge, recharge, disassemble, heat above (40°C) or incinerate. Doing so may result in injury due to venting, leakage or explosion resulting in chemical burns.
6. Ensure the batteries are installed correctly according to polarity (+ and -).
7. Do not mix old and new batteries, different brands or types of batteries, such as alkaline, carbon-zinc, or rechargeable batteries.
8. Remove and immediately recycle or dispose of batteries from equipment not used for an extended period of time according to local regulations.
9. Always completely secure the battery compartment. If the battery compartment does not close securely, stop using the product, remove the batteries, and keep them away from children.
10. Emitter couldn't expose to moisture or be struck heavily, or else the emitter life will be affected.
11. If the emitter is not so sensitive or the radio range becomes shorter, pls check whether to change the battery.
12. Under uni-directional mode, if you press any button more than 20S, while under bi-directional mode, you press any button 5S, the emitter will stop sending radio signals.

Switch Between Uni-directional And Bi-directional Mode

Note: 1, This operation takes DD315F as an example. The operation of DD316F is the same as DD315F.
2, The factory default mode is Bi-directional mode, repeat the same operation to switch the mode circularly.

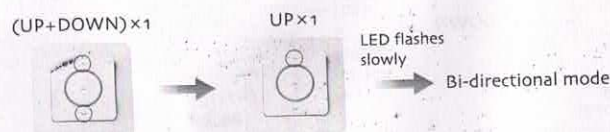
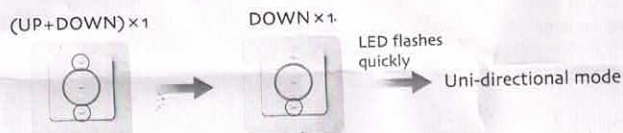

Lock / Unlock Combo-key Operation

Note: 1, This operation takes DD315F as an example. The operation of DD316F is the same as DD315F.
2, Both setting buttons on the back of the DD315F are available.
3, The factory default is unlock status, repeat same operation to switch status circularly.
4, When the combo-keys are locked, if you press the combo-keys, the emitter won't send any signal and LED won't flash.
5, Only the transmitting code will be affected if the combo-keys are locked.

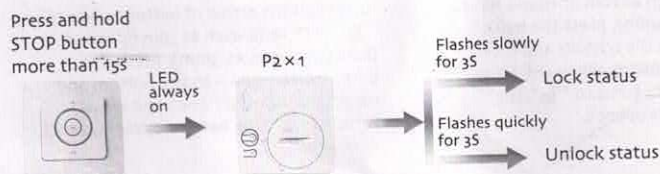

DD315F / DD316F

Emitter Instruction

Version: A/01

Instruction Of Buttons

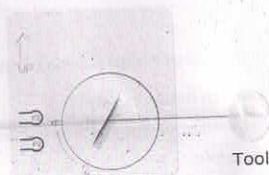
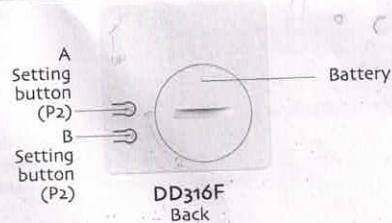
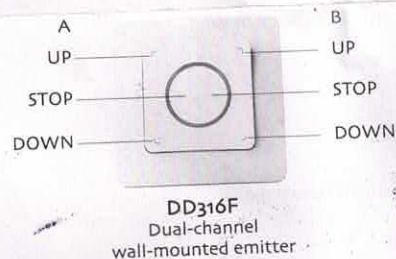
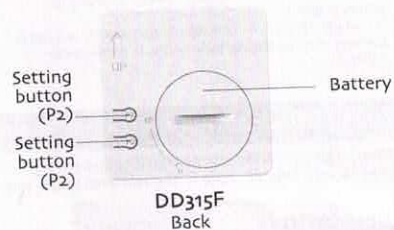
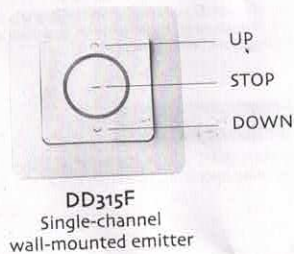

With tools such as coin or round flake (thickness $\leq 2.5\text{mm}$), press the battery cover down to the bottom and rotate at counterclockwise, when the arrow of battery cover turns to "🔓", the battery cover is opened

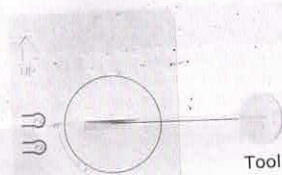

First align the arrow of battery cover to "🔓", with tools such as coin or round flake (thickness $\leq 2.5\text{mm}$), press the battery cover down to the bottom and rotate at clockwise, when the arrow turns to "🔒", the battery cover is closed